

12/2021

1. Drawing of the bathtub installation
Position der Wanne aufzeichnen

Nr. MK 22-1/2

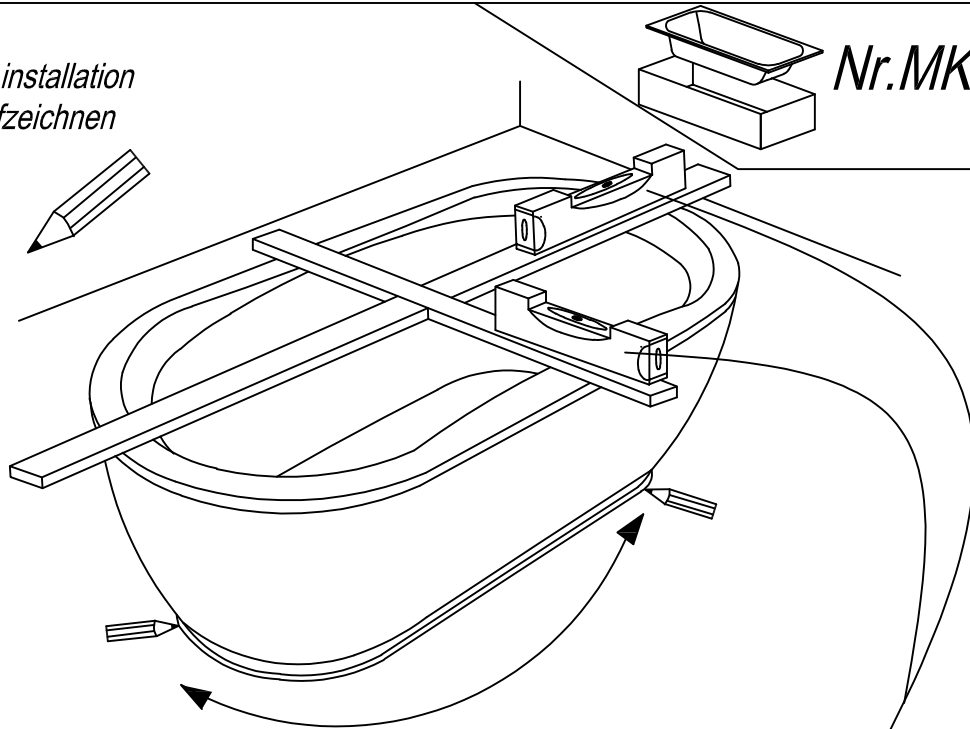

2. Leveling of the bathtub height
Höhe der Wanne nivellieren

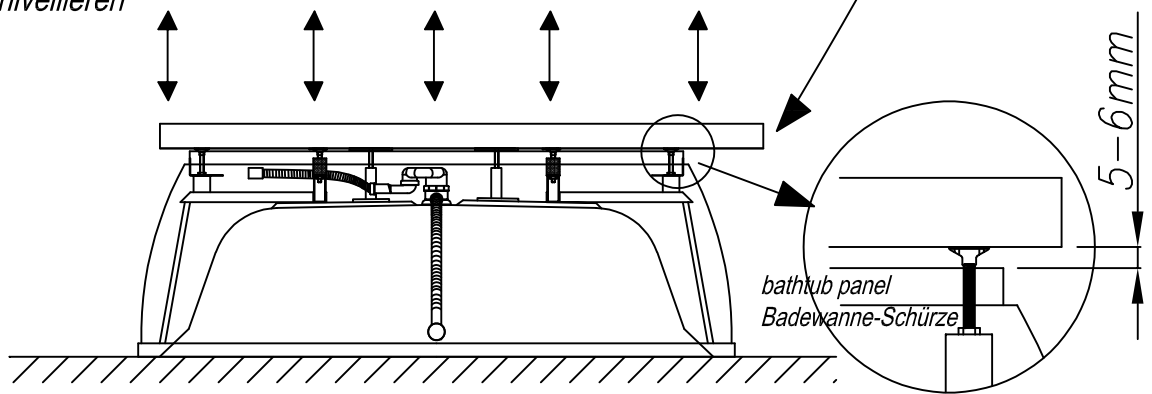
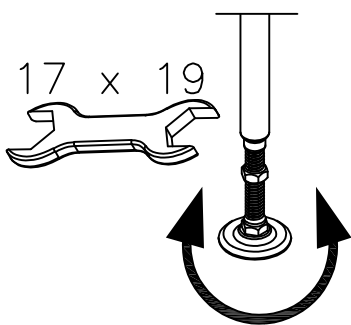

3. Installation of the bracket on the floor
Träger in den Boden befestigen

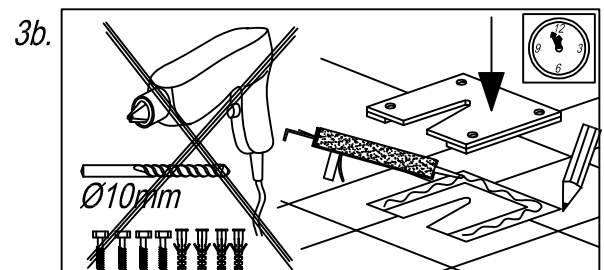
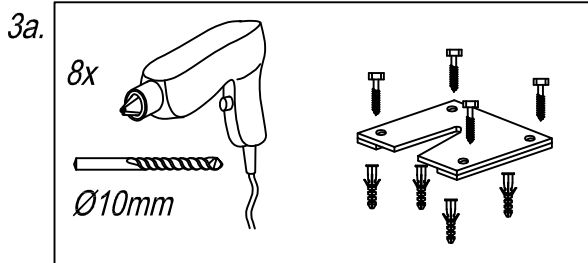
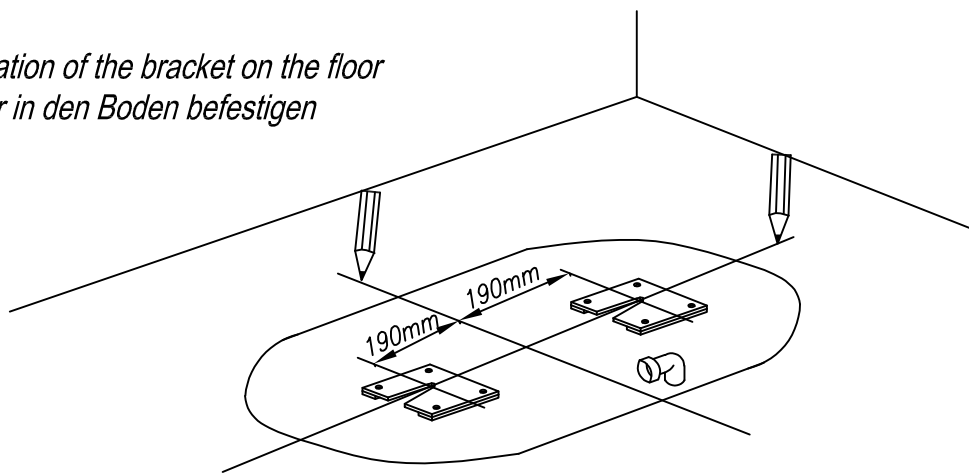

4. Installation of siphon
Siphon-Montage

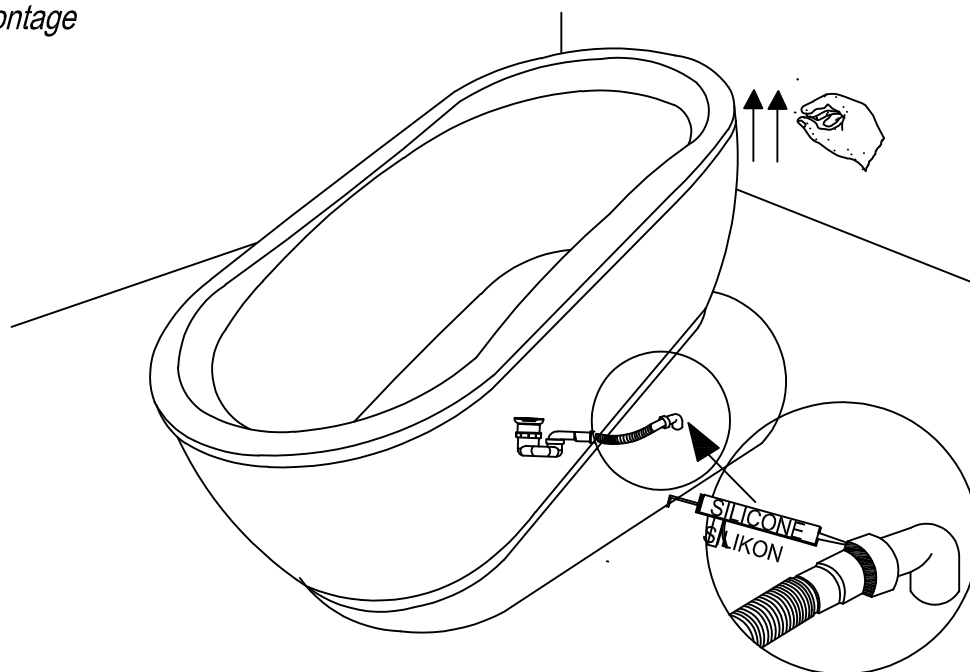

5. Installation of the bathtub in the mounted bracket
Badewanne in den fixierten Träger stellen

